

 Constructii existente
Limite de proprietate

-INTRAVILAN-
Teritoriul:
Adresa:
Proprietar:

MUNICIPIUL PLOIESTI
Mun. Ploiesti, Intrarea Lacauti, Nr. 11, judetul Prahova

1. Jujan Petre ,
2. Jujan Gheorghita,
3. Mihailescu Teodor-Razvan
4. Mihailescu Mirela
5. Gradinaru Eugen-Sebastian
6. Mihailescu Alexandra Ana,
7. Mihailescu Liviu
8. Mihailescu Sofia

Supr. teren studiată: S = 614 mp din care S = 421 mp nr.cadastral 139087, S=193mp Intrarea Lacauti,
-NR.CADASTRAL PROVIZORIU AL
CORPULUI DE PROPRIETATE: 139087

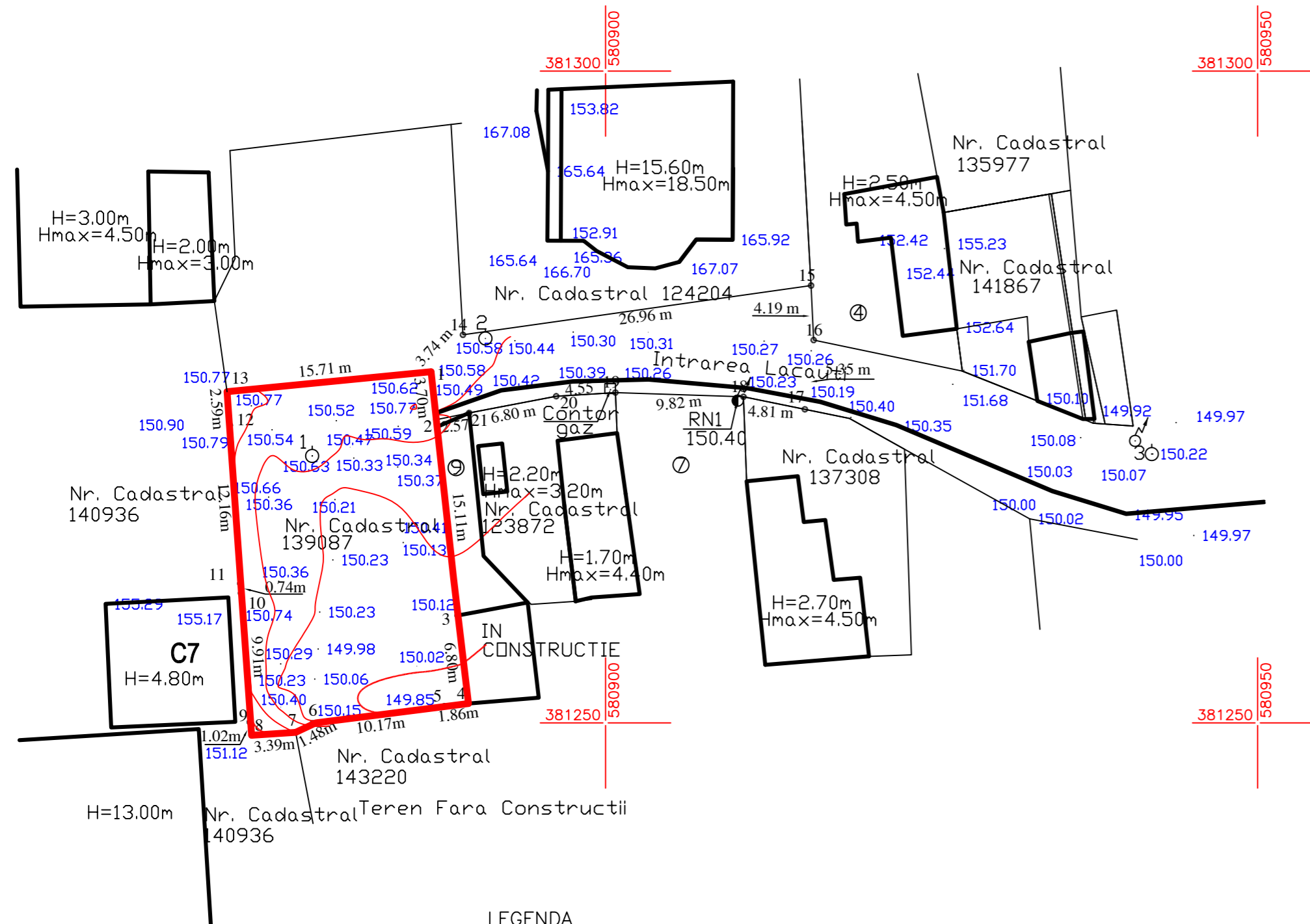

_____ gard de beton
 _____ gard metal
 _____ gard plasa
 ● stalp el. beton
 ⊙ statie topo

R.N.1
STALP ELECTRIC

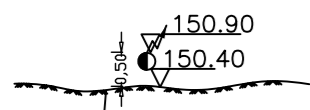

NOTA:

*Intocmit conform 453/2001 si 350/2001 precum si a normelor A.N.C.P.I. in vigoare -ordinul 700/2014



ELIPSOID: Krasovski
PROIECTIA: Stereografica 1970
SISTEM ALTIMETRIC: Marea Neagra 1975

CALCULUL ANALITIC AL SUPRAFETEI DE TEREN- NUMAR CADASTRAL 139087

NR CRT	DEN PUNCT CONT	COORDONATE		LATURA [m]
		X[m]	Y[m]	
1	1	381276.937	580886.623	3.743
2	14	381279.770	580889.070	26.956
3	15	381283.550	580915.760	4.188
4	16	381279.367	580915.959	5.354
5	17	381274.056	580915.285	4.805
6	18	381275.016	580910.577	9.821
7	19	381275.338	580900.761	4.550
8	20	381275.059	580896.220	6.795
9	21	381273.780	580889.546	2.568
10	2	381273.263	580887.031	15.115
11	3	381258.236	580888.658	6.804
12	4	381251.484	580889.494	1.863
13	5	381251.282	580887.642	10.175
14	6	381249.970	580877.552	1.478
15	7	381249.279	580876.246	3.387
16	8	381249.051	580872.867	1.022
17	9	381250.063	580872.722	9.908
18	10	381259.948	580872.048	0.744
19	11	381260.690	580871.994	12.162
20	12	381272.826	580871.203	2.594
21	13	381275.411	580870.986	15.711
1	1	381276.937	580886.623	

$$S = 614 \text{ mp}$$

NR CRT	DEN PUNCT CONT	COORDONATE		LATURA [m]
		X[m]	Y[m]	
1	1	381276.937	580886.623	<div>3.697</div> <div>15.115</div> <div>6.804</div> <div>1.863</div> <div>10.175</div> <div>1.478</div> <div>3.387</div> <div>1.022</div> <div>9.908</div> <div>0.744</div> <div>12.162</div> <div>2.594</div> <div>15.711</div>
2	2	381273.263	580887.031	
3	3	381258.236	580888.658	
4	4	381251.484	580889.494	
5	5	381251.282	580887.642	
6	6	381249.970	580877.552	
7	7	381249.279	580876.246	
8	8	381249.051	580872.867	
9	9	381250.063	580872.722	
10	10	381259.948	580872.048	
11	11	381260.690	580871.994	
12	12	381272.826	580871.203	
13	13	381275.411	580870.986	
1	1	381276.937	580886.623	

$$S = 421 \text{ mp}$$
[illegible]